

COMPRESSED AIR FILTER - LARGE

SF17 (G1, G1¼, G1½)

SHAVO
FIRST NAME IN PNEUMATICS

FEATURES

Shavo's Designer Series Large Flow Range general purpose Filter removes upto 99% of the liquid water.

Design of the filter elements gives both surface and depth filtration for cleaner air.

Ideally suited for header lines and large flow rated tools and cylinder operations.



PARAMETERS	SPECIFICATIONS
Pipe Threads	G 1, 1¼, 1½ Parallel (F) - Standard
Filter Element Size	5, 25, 40 micron
Element Material	Plastic (Polypropylene) - Standard Sintered Bronze - Optional
Body Material	Al. Alloy die-cast
Bowl Material	Al. Alloy Metal with sight glass - Standard
Maximum Inlet Pressure	with Metal Bowl (Manual drain) : 250 psig (17.5 bar) with Metal Bowl (Auto, Semiauto drain) : 150 psig (10.5 bar)
Maximum Operating Temperature (ambient)	80° C (175° F)
Standard Nominal Flow Rate At 6 bar (87 PSI) supply pressure and 14.5 PSI (1 bar) pressure drop	880 scfm (415 dm³/sec) C.V. (16.60)
Drain	Manual - Standard Automatic - Optional Semi Automatic - Optional

+ Values indicated are with 40 micron elements, with finer elements these values will be lower.

Note : Automatic drain and Semi-automatic drain available with Nitrile elastomer only.

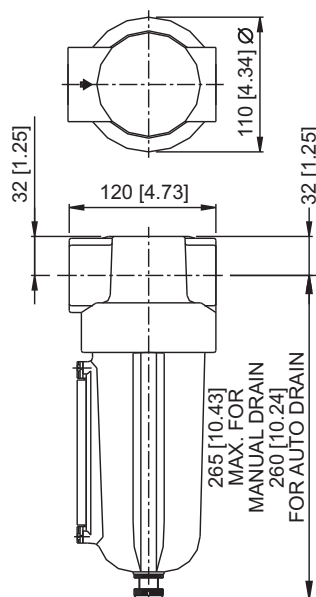

Technical know-how, design and drawings originally from C.A. Norgren Co. USA

SHAVO

Mumbai, India.

Email : shavo@shavoindia.com

COMPRESSED AIR FILTER - LARGE

SF17 (G1, G1¼, G1½)

SHAVO
FIRST NAME IN PNEUMATICS

Size	Flow (dm³/s)	Element (um)	Drain	Bowl	Model
G1	880 scfm (415 dm³/sec)	40	Auto Manual	Metal Metal	SF17-800-A3DC SF17-800-M3DC
	880 scfm (415 dm³/sec)	40	Auto Manual	Metal Metal	SF17-B00-A3DC SF17-B00-M3DC

Option Selector

Sample Model Number → **S F 1 7 - 8 0 0 - M 3 D C - X - X X X - X X X**

Position → **0 1 2 3 - 4 5 6 - 7 8 9 10 - 11 - 12 13 14 - 15 16 17**

0		S = Shavo															
1	Unit	F = Filter															
2	3	Series	17 = Large Series														
4	Pipe Size	8 = 1" NB A = 1¼" NB B = 1 ½" NB															
5	6	00 = Standard															
7	Drain	M = Manual Drain A = Automatic Drain (only available with Nitrile elastomers) S = Semi Auto Drain (only available with Nitrile elastomers)															
8	Filter Element	<table><tr><td>Size</td><td>Micron</td><td>5</td><td>25</td><td>40</td></tr><tr><td>Porous Plastic</td><td></td><td>1</td><td>-</td><td>3</td></tr><tr><td>Sintered Bronze</td><td></td><td>6</td><td>7</td><td>8</td></tr></table>	Size	Micron	5	25	40	Porous Plastic		1	-	3	Sintered Bronze		6	7	8
Size	Micron	5	25	40													
Porous Plastic		1	-	3													
Sintered Bronze		6	7	8													
9	Bowl	D = Metal Bowl with Sight Glass [M] = Metal Bowl without Sight Glass															
10	Thread	A = NPT B = BSPT C = BSP															
11	Elastomer	[X] = Standard Nitrile [E] = EPDM [V] = Viton [L] = Low Temperature Nitrile															

COMPRESSED AIR FILTER - LARGE

SF17 (G1, G1¼, G1½)

SHAVO
FIRST NAME IN PNEUMATICS

12 13 14 Test / Approval

C	0	0	CE
C	0	1	UKCA
C	0	2	CE, UKCA
E	0	0	EAC
E	0	1	EAC, UKCA
S	0	0	SIL3
S	0	1	SIL3, UKCA
G	0	0	CE, EAC
G	0	1	CE, EAC, UKCA
H	0	0	CE, SIL3
H	0	1	CE, SIL3, UKCA
K	0	0	CE, EAC, SIL3
K	0	1	CE, EAC, SIL3, UKCA
X	X	X	Standard Units Without Any Certificatios / Approval
[O]	[0]	[0]	Other Customer Special Requirement if Any

15 16 17 Compliance

X	X	X	Standard Unit Without any Compliance
A	0	1	RoHS 3 Compliance
A	0	2	REACH Compliance
A	0	3	Copper Free (Only Applicable Aluminium Version)
A	0	4	RoHS3, REACH Compliance
A	0	5	RoHS3, REACH, Copper Free (Only Applicable for Aluminium Version)
A	0	6	RoHS3, Copper Free (Only Applicable for Aluminium Version)
A	0	7	REACH, Copper Free (Only Applicable for Aluminium Version)

Note: Option shown in the [] bracket are special, Please contact Sales HQ/Manufacturing.

* Technical know-how, design and drawings originally from C.A. Norgren Co. USA