

## SR18 (G 1½, 2)

### Features

- Shavo's Pilot operated "Slave" Pressure Regulator can be installed at any point in the compressed air system without regard to accessibility ensuring accurate pressure regulation over a wide range of air flows upto 2000 cfm.
- Conventional or Feedback Pilot Regulators to operate the "Slave" regulator can be installed in the most convenient location.
- CE, ATEX, EAC Ex (CUTR 12), EAC(CUTR 10) approved.
- SIL 3 capable as per IEC 61508.

PARAMETERS	SPECIFICATIONS
Fluid	Compressed Air
Pipe Sizes	1 ½", 2"
Port Thread	BSP - Standard BSPT, NPT Optional
Max. Inlet Pressure	31 bar (450 psi)
Max. Operating Temp. (Ambient)	+80° C
Material of Construction	
Body, Bonnet	Aluminium Alloy die-cast
Internal parts	Aluminium, SS304, SS316L, Acetal resin, Nylon, brass
External parts	SS 316L
Diaphragm Assembly	Synthetic Rubber without PTFE - Standard
Elastomers	Low Temp. Nitrile (LNBR) -40°C to +80°C EPDM -35°C to +120°C Fluorocarbon (Viton-FKM) -20°C to +180°C
Standard Nominal Flow Rate at 10 bar (150psi) inlet pressure 6 bar (87 psi) set pr. and a drop of 1 bar(14.5 psi) from set	1½" - 1415 scfm (675 dm³/sec) 2" - 1890 scfm (900 dm³/sec)
CV Value	1½" - (26.70) 2" - (35.70)
Type	Relieving - Std Non-Relieving - Optional
Pressure Adjustment	With the help of a Pilot Regulator either standard or Feedback
Regulated secondary pressure range available	upto 17.5 kg/cm².
Gauge Port size	G 1/4"
Gauge size (dial size)	50 mm (Nominal)
Mounting	Panel Mounting - Standard Mounting Bracket - Optional
Weight	3.5 Kgs.

Pressure Gauge (scale) : Kg/cm<sup>2</sup> (PSI) - Standard (For Domestic Market)  
Bar (PSI) - Standard (Export)

\* Pressure gauge will not have CE, EAC, SIL3 and NACE MR 0175 approval



Size	Flow	Range (psi)	Operation	Model
G 1½	1415 scfm (675 dm³/sec)	15-150 psi	Relieving	SR18-B00-RNXD-A
G 2	1890 scfm (900 dm³/sec)	15-150 psi	Relieving	SR18-C00-RNXD-A

# SR18 (G 1½, 2)

## Option Selector

Sample Model Number → **S R 1 8 - C G - R G X - R T O - M - X X X - E - X X X**

Position → **0 1 2 3 - 4 5 - 6 7 8 - 9 10 11 - 12 - 13 14 15 - 16 - 17 18 19**

**0** S = Shavo

**1** Product R = Regulator

**2 3** Series 18 = High Flow Regulator Series

**4** Pipe Size  
B = 1½"  
C = 2"

**5** Port Thread

	Main Port	Gauge Port
A	NPT	BSPT
B	BSPT	BSPT
G/D	BSP	BSPT
N	NPT	NPT

**6** Functional  
R = Relieving  
N = Non-Relieving

**7** Gauge  
N = No Gauge  
G = With Gauge with ATEX approved-50mm

**8** Relief  
X = Standard (No Spring)

**Pilot Regulator details:**

**9 10 11**  
R07 = Conventional Pilot Model R07 1/4"  
R02 = Conventional Pilot Model R02 1/4"  
R20 = Conventional Pilot Model R20 1/4"  
SNR = Conventional Pilot Model 11-4SNR 1/4"  
R28 = Feed Back Pilot Model R28 1/4"

**12** Sec.range Pilot regulator  
A = 0.07 TO 0.7 bar  
C = 0.21 TO 2.1 bar  
E = 0.35 TO 3.5 bar  
F = 0.4 TO 4.0 bar  
K = 0.7 TO 7.0 bar  
L = 0.85 TO 8.75 bar  
M = 1.00 TO 10.0 bar  
\*S = 1.75 TO 17.5 bar (where available) ('T' Handle)

A	0	0	ATEX
A	0	1	UKEX
A	0	2	UKCA
A	0	3	ATEX, UKEX, EAC Ex, UKCA
A	0	4	ATEX, UKEX, EAC Ex
A	0	5	ATEX, UKEX, UKCA
A	0	6	ATEX, UKEX, EAC Ex
B	0	0	ATEX, CE
B	0	1	ATEX, CE, UKEX, EAC Ex, UKCA
B	0	2	ATEX, CE, UKEX, EAC Ex
B	0	3	ATEX, CE, UKEX, UKCA
B	0	4	ATEX, CE, UKCA, EAC Ex
B	0	5	ATEX, CE, EAC Ex
C	0	0	CE
C	0	1	CE, UKEX, EAC Ex, UKCA
C	0	2	CE, UKEX, EAC Ex
C	0	3	CE, UKEX, UKCA
C	0	4	CE, EAC Ex, UKCA
C	0	5	CE, EAC Ex

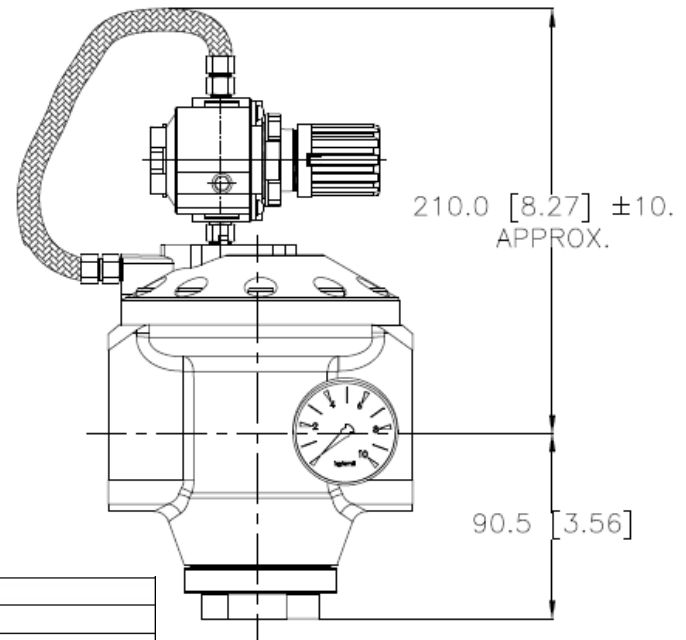
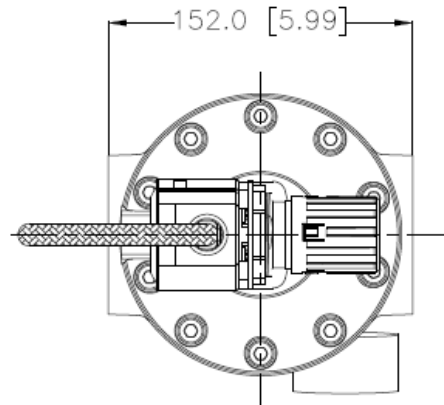

**13 14 15** Test / Approval

## SR18 (G 1½, 2)

D	0	0	ATEX, EAC
D	0	1	ATEX, EAC, UKEX, EAC Ex, UKCA
D	0	2	ATEX, EAC, UKEX, EAC Ex
D	0	3	ATEX, EAC, UKEX, UKCA
D	0	4	ATEX, EAC, EAC Ex, UKCA
E	0	0	EAC
E	0	1	EAC, UKEX, EAC Ex, UKCA
E	0	2	EAC, UKEX, EAC Ex
E	0	3	EAC, UKEX, UKCA
E	0	4	EAC, EAC Ex, UKCA
F	0	0	ATEX, SIL3
F	0	1	ATEX, SIL3, UKEX, EAC Ex, UKCA
F	0	2	ATEX, SIL3, UKEX, EAC Ex
F	0	3	ATEX, SIL3, UKEX, UKCA
F	0	4	ATEX, SIL3, EAC Ex, UKCA
F	0	5	ATEX, SIL3, EAC Ex
G	0	0	CE, EAC
G	0	1	CE, EAC, UKEX, EAC Ex, UKCA
G	0	2	CE, EAC, UKEX, EAC Ex
G	0	3	CE, EAC, UKEX, UKCA
G	0	4	CE, EAC, EAC Ex, UKCA
H	0	0	CE, SIL3
H	0	1	CE, SIL3, UKEX, EAC Ex, UKCA
H	0	2	CE, SIL3, UKEX, EAC Ex
H	0	3	CE, SIL3, UKEX, UKCA
H	0	4	CE, SIL3, EAC Ex, UKCA
H	0	5	CE, SIL3, EAC Ex
J	0	0	EAC, SIL3
J	0	1	EAC, SIL3, UKEX, EAC Ex, UKCA
J	0	2	EAC, SIL3, UKEX, EAC Ex
J	0	3	EAC, SIL3, UKEX, UKCA
J	0	4	EAC, SIL3, EAC Ex, UKCA
K	0	0	CE, EAC, SIL3
K	0	1	CE, EAC, SIL3, UKEX, EAC Ex, UKCA
K	0	2	CE, EAC, SIL3, UKEX, UKCA
K	0	3	CE, EAC, SIL3, UKEX, EAC Ex
K	0	4	CE, EAC, SIL3, EAC Ex, UKCA
L	0	0	ATEX, EAC, SIL3
L	0	1	ATEX, EAC, SIL3, UKEX, EAC Ex, UKCA
L	0	2	ATEX, EAC, SIL3, UKEX, EAC Ex
L	0	3	ATEX, EAC, SIL3, UKEX, UKCA
L	0	4	ATEX, EAC, SIL3, EAC Ex, UKCA
M	0	0	ATEX, CE, SIL3
M	0	1	ATEX, CE, SIL3, UKEX, EAC Ex, UKCA
M	0	2	ATEX, CE, SIL3, UKEX, EAC Ex
M	0	3	ATEX, CE, SIL3, UKEX, UKCA
M	0	4	ATEX, CE, SIL3, EAC Ex, UKCA
N	0	0	ATEX, CE, EAC
N	0	1	ATEX, CE, EAC, UKEX, EAC Ex, UKCA
N	0	2	ATEX, CE, EAC, UKEX, EAC Ex
N	0	3	ATEX, CE, EAC, UKEX, UKCA
N	0	4	ATEX, CE, EAC, EAC Ex, UKCA

SR18 (G 1½, 2)

[O]	[0]	[0]	Other customer special requirement if Any
P	0	0	ATEX, CE, EAC, SIL3
P	0	1	ATEX, CE, EAC, SIL3, UKEX, EAC Ex, UKCA
P	0	2	ATEX, CE, EAC, SIL3, UKEX, EAC Ex
P	0	3	ATEX, CE, EAC, SIL3, UKEX, UKCA
P	0	4	ATEX, CE, EAC, SIL3, EAC Ex, UKCA
Q	0	0	ATEX, EAC Ex
R	0	0	EAC Ex
R	0	1	EAC Ex, UKEX, UKCA
R	0	2	EAC Ex, UKCA
S	0	0	SIL3
S	0	1	SIL3, UKEX, EAC Ex, UKCA
S	0	2	SIL3, UKEX, EAC Ex
S	0	3	SIL3, UKEX, UKCA
S	0	4	SIL3, EAC Ex, UKCA
V	0	0	ATEX, CE, SIL3, EAC Ex
V	0	1	ATEX, CE, SIL3, EAC Ex, UKEX, UKCA
V	0	2	ATEX, CE, SIL3, EAC Ex, UKEX
V	0	3	ATEX, CE, SIL3, EAC Ex, UKCA
X	X	X	STANDARD UNITS WITHOUT ANY CERTIFICATE / APPROVAL
Y	0	0	ATEX, SIL3, EACEx
y	0	1	ATEX, SIL3, EACEx, UKEX, UKCA
Y	0	2	ATEX, SIL3, EAC Ex, UKEX
Y	0	3	ATEX, SIL3, EACEx, UKCA
Z	0	1	CE, SIL3, EAC Ex, UKEX, UKCA
Z	0	2	CE, SIL3, EAC Ex, UKEX
Z	0	3	CE, SIL3, EAC Ex, UKCA

16 Elastomers

L	=	Low temperature Nitrile (LNBR)
[E]	=	E
[V]	=	iton

17 18 19 Compliance

X	X	X	Standard Unit Without any Compliance
A	0	1	RoHS 3 Compliance
A	0	2	REACH Compliance
A	0	3	Copper Free (Only Applicable Aluminium Version)
A	0	4	RoHS3, REACH Compliance
A	0	5	RoHS3, REACH, Copper Free (Only Applicable for Aluminium Version)
A	0	6	RoHS3, Copper Free (Only Applicable for Aluminium Version)
A	0	7	REACH, Copper Free (Only Applicable for Aluminium Version)

Note : Option shown in [ ] bracket are special, please contact manufacturing.

\* [S] option available with Hex headed pressure adj .