

VB60 (G 1/2, G 3/4) (SS316L) - HIGH FLOW

Features

- Shavo's type 60 Volume Booster amplifies the volume at a 1:1 ratio whenever input isolation or increased flow capacity is required.
- High capacity Volume Booster, with a fixed minimum deadband, are designed to substantially improve the stroking speed of large actuators.
- An integral adjustable bypass valve provide good operational system stability over wide range of actuator sizes.
- Soft Valve seat design minimizes air consumption.
- CE, ATEX, EAC [(CUTR-10) equivalent to GOST R &K] approved.
- SIL3 capable as per IEC 61508.
- All External parts are NACE MR 0175* approved.

(*National Association of Corrosion Engineers MR-0175 defines requirements for sulphide stress cracking resistant materials used in oilwells and corrosive environments).

PARAMETERS	SPECIFICATIONS
Fluid	Compressed Air
Pipe size	1/2" , 3/4"
Pipe Thread	NPT - Standard
(Supply/output connection)	BSPT, BSP - Optional
Signal Connection	1/4" NPT - Standard
Signal / Output Ratio	1 : 1
Supply Pressure	150 psig (10 bar) maximum (not to exceed actuator rating)
Signal / Output Pressure	100 psig (7.0 bar) maximum
Flow Capacity	
Standard Nominal Flow Rate at 150 psi (10 bar) inlet pressure 87 psi (6 bar) set pressure and a drop of 14.5 psi(1 bar) from set	1/2" or 3/4" - 200 scfm (5670 lpm) CV : 3.80
Flow capacity (CV)	Exhaust : 3.80 Output : 3.80
Signal to output ratio	1:1 ±5% of 100 psi output span
Maximum Operating Temperature	+80°C
Linearity	±1% (FS)
Material of Construction	
Body, Spacer, Top cover	SS316L
Internals wetted parts	SS316L, SS304 etc.
Elastomers	Low temperature Nitrile : -60°C to +80°C
Weight	5.5 Kgs.
Gauge (dial size)	50 mm nominal - Std.

Pressure Gauge (scale) : Kg/cm² (PSI) - Standard (For Domestic Market)
Bar (PSI) - Standard (Export)

Note :Screw, mounting bracket and pressure gauge will not be NACE MR 0175 approved.
Pressure gauge will be ATEX approved.
Pressure gauge will not be CE, SIL3,EAC approved.
Gauge dial size 50mm standard.
Exhaust port - M8 tapped.



ATEX version



Non-ATEX version

VB60 (G 1/2, G 3/4) (SS316L) - HIGH FLOW

Option Selector

Sample Model Number → S V B 6 0 - S H 4 A - N B - X X X - N - X X X

Position → 0 1 2 3 4 - 5 6 7 8 - 9 10 - 11 12 13 - 14 - 15 16 17

0 S = Shavo

1 2 Product VB = Volume Booster

3 4 Series 60 = Basic Designer

5 Basic MOC S = SS316L MOC (Body, Spacer, Top cover)

6 Flow H = High Flow

7 Size
4 = 1/2"
6 = 3/4"

8 Port Threads

Type	Main Port	Gauge Port	Signal Port
A	NPT	BSPT	1/4" NPT
B	BSPT	BSPT	1/4" BSPT
G	BSP	BSPT	1/4" NPT
N	NPT	NPT	1/4" NPT

9 Elastomer Material L = Low Temperature NBR

10 Mounting
N = No Mounting Bracket
[B] = Standard Mounting Bracket

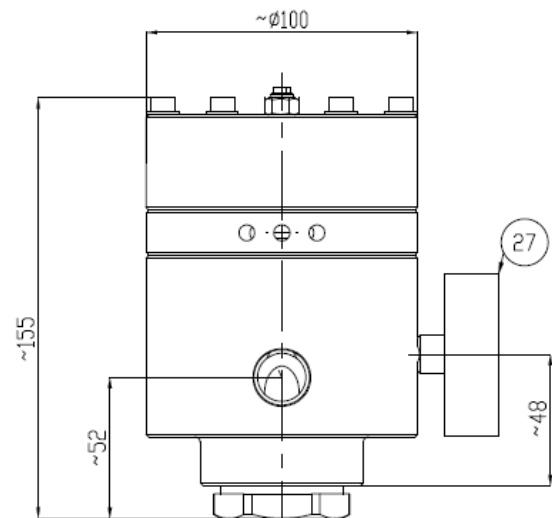
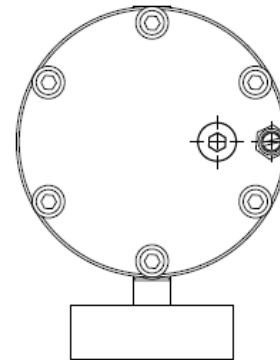

11 12 13 Test / Approval

A	0	0	ATEX
A	0	1	UKEX
A	0	2	UKCA
A	0	3	ATEX, UKEX, EAC Ex, UKCA
A	0	4	ATEX, UKEX, EAC Ex
A	0	5	ATEX, UKEX, UKCA
A	0	6	ATEX, UKEX, EAC Ex
B	0	0	ATEX, CE
B	0	1	ATEX, CE, UKEX, EAC Ex, UKCA
B	0	2	ATEX, CE, UKEX, EAC Ex
B	0	3	ATEX, CE, UKEX, UKCA
B	0	4	ATEX, CE, UKCA, EAC Ex
B	0	5	ATEX, CE, EAC Ex
C	0	0	CE
C	0	1	CE, UKEX, EAC Ex, UKCA
C	0	2	CE, UKEX, EAC Ex
C	0	3	CE, UKEX, UKCA
C	0	4	CE, EAC Ex, UKCA
C	0	5	CE, EAC Ex

VB60 (G 1/2, G 3/4) (SS316L) - HIGH FLOW

D	0	0	ATEX, EAC
D	0	1	ATEX, EAC, UKEX, EAC Ex, UKCA
D	0	2	ATEX, EAC, UKEX, EAC Ex
D	0	3	ATEX, EAC, UKEX, UKCA
D	0	4	ATEX, EAC, EAC Ex, UKCA
E	0	0	EAC
E	0	1	EAC, UKEX, EAC Ex, UKCA
E	0	2	EAC, UKEX, EAC Ex
E	0	3	EAC, UKEX, UKCA
E	0	4	EAC, EAC Ex, UKCA
F	0	0	ATEX, SIL3
F	0	1	ATEX, SIL3, UKEX, EAC Ex, UKCA
F	0	2	ATEX, SIL3, UKEX, EAC Ex
F	0	3	ATEX, SIL3, UKEX, UKCA
F	0	4	ATEX, SIL3, EAC Ex, UKCA
F	0	5	ATEX, SIL3, EAC Ex
G	0	0	CE, EAC
G	0	1	CE, EAC, UKEX, EAC Ex, UKCA
G	0	2	CE, EAC, UKEX, EAC Ex
G	0	3	CE, EAC, UKEX, UKCA
G	0	4	CE, EAC, EAC Ex, UKCA
H	0	0	CE, SIL3
H	0	1	CE, SIL3, UKEX, EAC Ex, UKCA
H	0	2	CE, SIL3, UKEX, EAC Ex
H	0	3	CE, SIL3, UKEX, UKCA
H	0	4	CE, SIL3, EAC Ex, UKCA
H	0	5	CE, SIL3, EAC Ex
J	0	0	EAC, SIL3
J	0	1	EAC, SIL3, UKEX, EAC Ex, UKCA
J	0	2	EAC, SIL3, UKEX, EAC Ex
J	0	3	EAC, SIL3, UKEX, UKCA
J	0	4	EAC, SIL3, EAC Ex, UKCA
K	0	0	CE, EAC, SIL3
K	0	1	CE, EAC, SIL3, UKEX, EAC Ex, UKCA
K	0	2	CE, EAC, SIL3, UKEX, UKCA
K	0	3	CE, EAC, SIL3, UKEX, EAC Ex
K	0	4	CE, EAC, SIL3, EAC Ex, UKCA
L	0	0	ATEX, EAC, SIL3
L	0	1	ATEX, EAC, SIL3, UKEX, EAC Ex, UKCA
L	0	2	ATEX, EAC, SIL3, UKEX, EAC Ex
L	0	3	ATEX, EAC, SIL3, UKEX, UKCA
L	0	4	ATEX, EAC, SIL3, EAC Ex, UKCA
M	0	0	ATEX, CE, SIL3
M	0	1	ATEX, CE, SIL3, UKEX, EAC Ex, UKCA
M	0	2	ATEX, CE, SIL3, UKEX, EAC Ex
M	0	3	ATEX, CE, SIL3, UKEX, UKCA
M	0	4	ATEX, CE, SIL3, EAC Ex, UKCA
N	0	0	ATEX, CE, EAC
N	0	1	ATEX, CE, EAC, UKEX, EAC Ex, UKCA
N	0	2	ATEX, CE, EAC, UKEX, EAC Ex
N	0	3	ATEX, CE, EAC, UKEX, UKCA

VB60 (G 1/2, G 3/4) (SS316L) - HIGH FLOW

N	0	4	ATEX, CE, EAC, EAC Ex, UKCA
[O]	[0]	[0]	Other customer special requirement if Any
P	0	0	ATEX, CE, EAC, SIL3
P	0	1	ATEX, CE, EAC, SIL3, UKEX, EAC Ex, UKCA
P	0	2	ATEX, CE, EAC, SIL3, UKEX, EAC Ex
P	0	3	ATEX, CE, EAC, SIL3, UKEX, UKCA
P	0	4	ATEX, CE, EAC, SIL3, EAC Ex, UKCA
Q	0	0	ATEX, EAC Ex
R	0	0	EAC Ex
R	0	1	EAC Ex, UKEX, UKCA
R	0	2	EAC Ex, UKCA
S	0	0	SIL3
S	0	1	SIL3, UKEX, EAC Ex, UKCA
S	0	2	SIL3, UKEX, EAC Ex
S	0	3	SIL3, UKEX, UKCA
S	0	4	SIL3, EAC Ex, UKCA
V	0	0	ATEX, CE, SIL3, EAC Ex
V	0	1	ATEX, CE, SIL3, EAC Ex, UKEX, UKCA
V	0	2	ATEX, CE, SIL3, EAC Ex, UKEX
V	0	3	ATEX, CE, SIL3, EAC Ex, UKCA
X	X	X	STANDARD UNITS WITHOUT ANY CERTIFICATE / APPROVAL
Y	0	0	ATEX, SIL3, EACEx
Y	0	1	ATEX, SIL3, EACEx, UKEX, UKCA
Y	0	2	ATEX, SIL3, EAC Ex, UKEX
Y	0	3	ATEX, SIL3, EACEx, UKCA
Z	0	1	CE, SIL3, EAC Ex, UKEX, UKCA
Z	0	2	CE, SIL3, EAC Ex, UKEX
Z	0	3	CE, SIL3, EAC Ex, UKCA

14 Pressure Gauge

N = No Gauge
 [G] = With Pressure Gauge
 (0-16 kg/cm². without ATEX, CE, SIL3 approved.)

15 16 17 Compliance

X	X	X	Standard Unit Without any Compliance
A	0	1	RoHS 3 Compliance
A	0	2	REACH Compliance
A	0	3	Copper Free (Only Applicable Aluminium Version)
A	0	4	RoHS3, REACH Compliance
A	0	5	RoHS3, REACH, Copper Free (Only Applicable for Aluminium Version)
A	0	6	RoHS3, Copper Free (Only Applicable for Aluminium Version)
A	0	7	REACH, Copper Free (Only Applicable for Aluminium Version)

Options shown in [] brackets are special, please contact sales HQ / manufacturing.